



Pumps and Replacement Parts

Quality, Readily Available Pumps at a Fair price

'S' SERIES HEAVY DUTY VERTICAL CANTILEVER SHAFT SLURRY SUMP PUMPS



WET ENDS AVAILABLE:
27% CHROME IRON METAL
RUBBER
URETHANE



Pumps and Replacement Parts

Quality, Readily Available Pumps at a Fair price

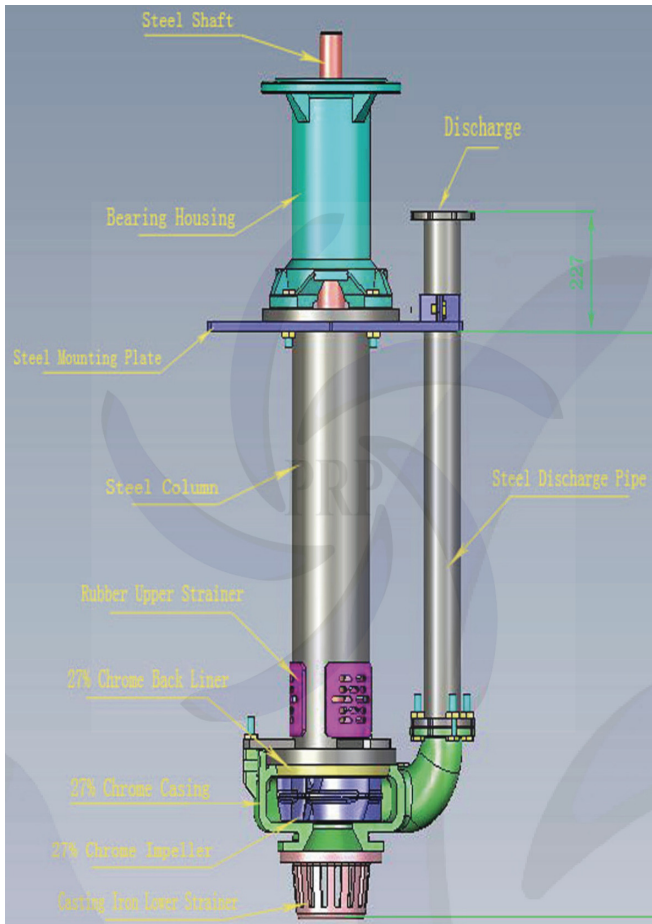

Applications

The 'S' Series Sump Pumps are a vertical heavy duty cantilever sump pump designed for slurry sump services for:

- Abrasive and Corrosive sump applications.
- Concentric casing minimises shaft load over wide operating range and reduces wear.
- Cantilever Shaft Design results in no wetted bearing and seal wear.
- Heavy duty shaft and cast bearing housings result in increased critical speeds and lower vibration levels than competitor equipment.
- Modern Bearing Isolators keep contaminants out of bearing housing and increase bearing life.
- Large solids sizes pumped.
- Will run continuously on snore.

Wet End Materials A wide range of wet end materials are available including:

27% Chrome Iron (600BHN): Recommended for the majority of sump services. This slurry grade white iron ensures tramp washed into sump as well as sharp particles and elevated temperature slurries are handled with ease.

Natural Rubber: A special grade natural rubber is available for services which are slightly acidic and where the slurry comprises fine particles.

Hypalon: Ideal for concentrated acidic duties .

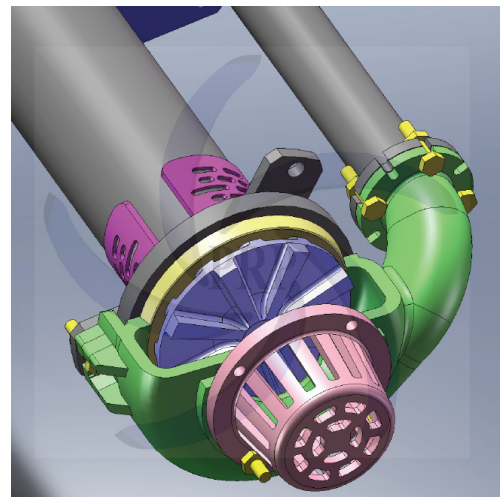

Options:

Setting Depths: The standard setting depths are suitable for commonly found sump sizes. Other setting depths are available on request.

Suction Pipe: A suction pipe is available to enable deeper sumps to drain. The pump primes when above the top strainer, then will pump out to lower depths.

Vortex Impellers: Ideal for air entrained duties and fragile pumpages as carbon transfer.

Conical Sumps: The pump can be provided in a pre-fabricated conical sump with quick clean out facilities.

Direct Drive: The standard and recommended pump configuration is belt driven. Direct drive is available at extra charge.